



ABOUT BRIER CREEK COMMONS

Brier Creek Commons is a 771,442 square foot open-air lifestyle center, combining sought after national retailers with unique specialty shops, entertainment and restaurants. Located in one of Raleigh’s most affluent and rapidly growing submarkets, this center includes major tenants such as BJ’s, Dick’s Sporting Goods, HomeGoods, Michael’s, ROSS Dress For Less, TJ Maxx, and Target to name a few.



DEMOGRAPHICS

<i>Population</i>	<i>2018</i>	<i>2023</i>
3 Mile Radius	35,291	39,707
5 Mile Radius	84,400	95,859
10 Mile Radius	525,782	584,354
<i>Median Household Income</i>		
3 Mile Radius	\$80,498	\$85,052
5 Mile Radius	\$81,811	\$86,050
10 Mile Radius	\$74,366	\$79,866
<i>Total Households</i>		
3 Mile Radius	15,616	17,583
5 Mile Radius	35,945	40,846
10 Mile Radius	216,527	240,102
<i>Median Age</i>		
	36.4	



Brier Creek Commons

BRIER CREEK COMMONS SHOPPING CENTER

Raleigh, North Carolina

LEASING INFORMATION

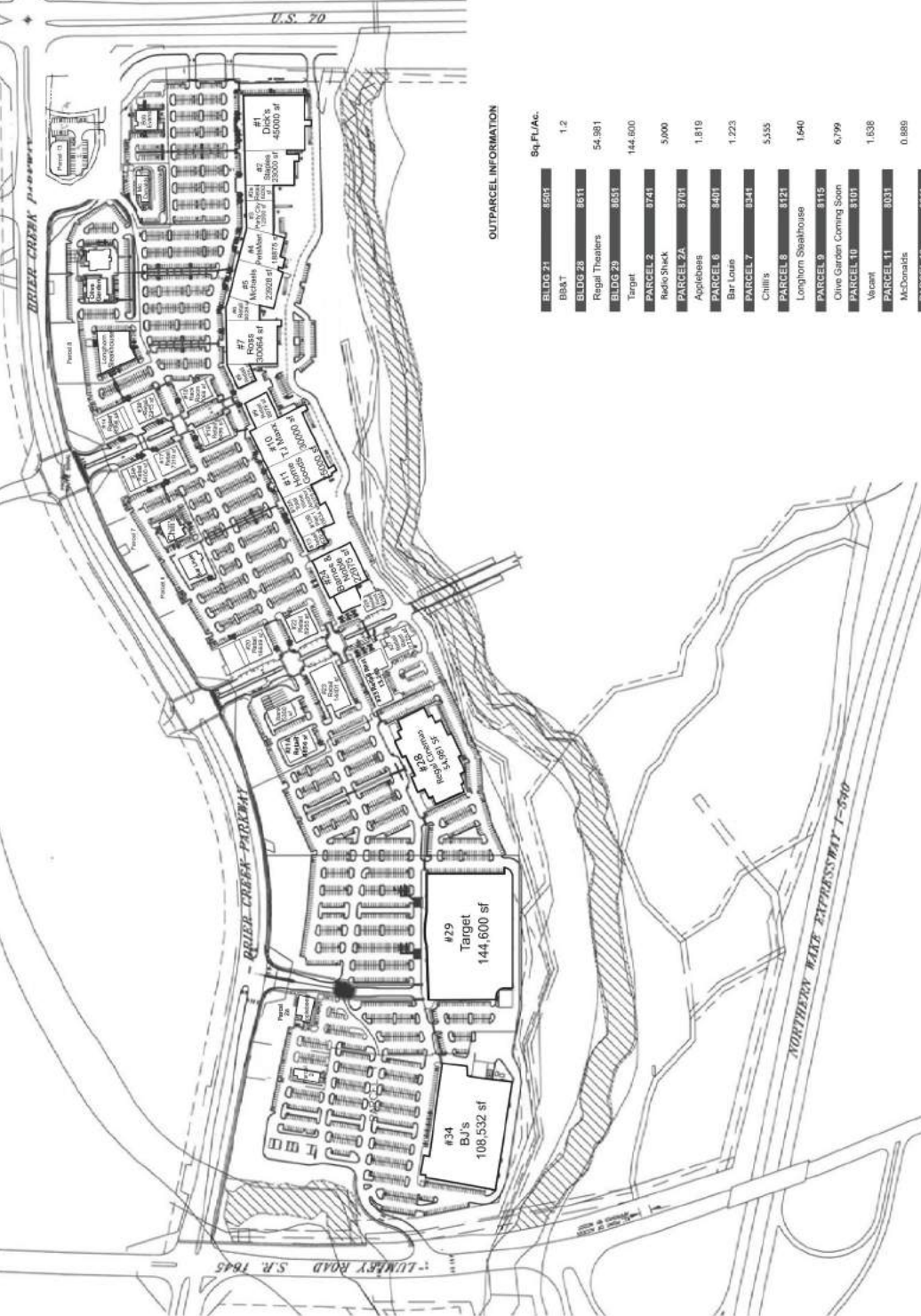

BLDG #	Sq. Ft./Ac.
BLDG 22	8,221
(107) Milano Shoppes	4,000
(107) Milano Shoppes	4,985
BLDG 23	8,351
(103) Brier Creek Beer Canteen	2,500
(103) Rocky Mtn. Chocolate	1,150
(105) GGR & Cakesakes	1,161
(105) GGR & Cakesakes	1,161
(115) Glow Tan & Beauty	2,019
(117) Weich Wich	1,200
(119) Chang's Thai & Sushi	3,000
BLDG 24	8,431
Barnes & Noble	22,975
BLDG 25	8,531
(101) Men's Wearhouse	5,847
(101) Men's Wearhouse	2,500
(111) Tensard Eatery	2,500
(113) The Joint	1,210
(115) Max Ice Cream	1,216
BLDG 26A	8,441
Tabacs	5,949
BLDG 26B	8,451
(101) Bo Hair Salon	4,242
BLDG 27	8,551
Braza Brazilian Steakhouse	7,725
BLDG 24	8,511
BJ's	108,532
TOTAL SQ. FT.	510,217

BLDG #	Sq. Ft./Ac.
BLDG 1	8,021
Dick's Sporting Goods	45,000
BLDG 2	8,041
Supab	23,000
BLDG 2A	8,081
(101) Dunkin' Donuts	4,382
(101) Dunkin' Donuts	1,088
BLDG 3	8,091
(115) Party City	12,000
BLDG 4	8,111
PETSMART	18,860
BLDG 6	8,131
Michaels	23,028
BLDG 6	8,161
Venona	9,026
BLDG 7	8,191
Ross Dress for Less	30,064
BLDG 8	8,231
(104) My Eye Dr.	5,875
BLDG 9	8,331
(103) Michaels	3,375
(103) Lens Pro Opt.	3,000
BLDG 10	8,361
TJ Maxx	30,000
BLDG 11	8,371
HomeGoods	25,000
BLDG 12A	8,381
Total Wine and More	9,375
BLDG 12B	8,391
Peer Opt	10,834
BLDG 13	8,399
Bath & Body Works	4,820
BLDG 14	8,201
(101) Caribou Coffee	1,568
(103) Massage Envy	1,960
(105) Massage Envy	3,000
(107) Auddin's Eatery	1,800
BLDG 15	8,301
(101) Rite Biscuits & Donuts	2,835
(103) Brier Creek Dentistry	1,782
(107) Shimmer & Shine	2,500
(107) Shimmer & Shine	2,980
BLDG 16	8,211
(101) Amazing Lush Studio	1,900
(105) Bruegger's	1,556
(105) Bruegger's	1,556
(107) Alopec Chicken	2,500
BLDG 17	8,311
(101) GNC	1,237
(103) Ulta Cosmetics	1,882
(107) Verizon	3,000
BLDG 18	8,221
Reck Room Shoes	7,068
BLDG 19	8,121
(101) Dairy Queen	1,200
(103) Advance Tailors	1,100
(107) Tins2Tees	2,996
(109) Onyx	1,990
BLDG 20	8,411
(101) Aultra	4,286
(103) Sally Beauty	1,526
(105) Unimart Japanese	6,588
(107) Edward Jones	968
(109) Noodles & Company	3,000
BLDG 21	8,501
BB&T	5,900
BLDG 21A	8,511
BlueCross BlueShield	4,856
Blue Pizza	4,200

OUTPARCEL INFORMATION

BLDG #	Sq. Ft./Ac.
BLDG 21	8,601
BB&T	1.2
BLDG 28	8,631
Regal Theaters	54,981
BLDG 29	8,651
Target	144,600
PARCEL 2	8,741
Radio Shack	5,000
PARCEL 2A	8,701
Applebees	1,819
PARCEL 6	8,401
Bar Louie	1,223
PARCEL 7	8,241
Chili's	5,555
PARCEL 8	8,121
Longton Steakhouse	1,640
PARCEL 9	8,115
Olive Garden Conno Snoon	6,799
PARCEL 10	8,101
Vacant	1,538
PARCEL 11	8,031
McDonalds	0,888
PARCEL 12	8,011
Bo's Events	1,239
PARCEL 13	8,001
AT&T	1.10
Mailboxes Firm	
Jimmy Johns	

Revised 05.23.19

